

1	2	3	4	5	6
REV.	DESCRIPTION	ECN NO.	NAME	DATE	
2	NEW FRAME	N/A	HYH	2020-07-07	

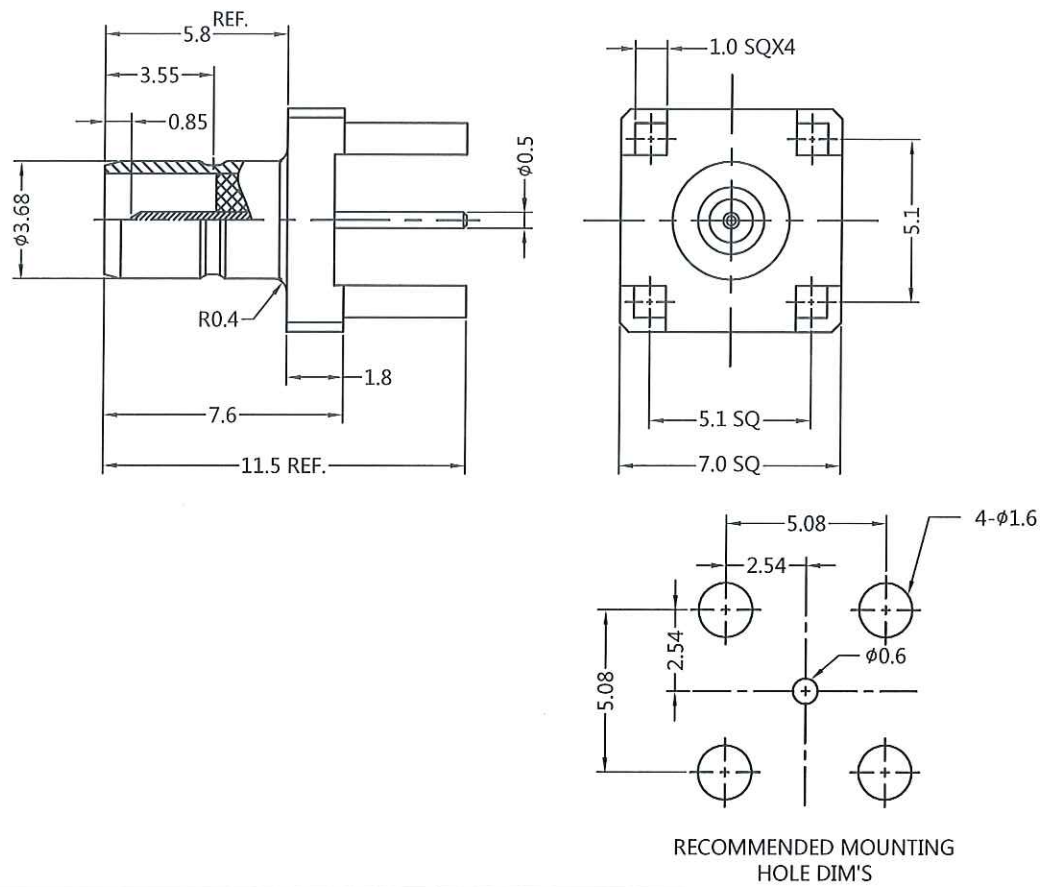

ALL PARTS MUST MEET TO RoHS REQUIREMENTS



MATERIALS AND PLATING		UNIT: MICRO-INCHES
PART NAME	MATERIALS	PLATING
BODY	BRASS C36000	GOLD PL.8u"/CHEMIACL NICKEL /COPPER
CONTACT PIN	BRASS C36000	GOLD PL.35u"/CHEMIACL NICKEL /COPPER
INSULATOR	TEFLON MIL-P-19468	N/A

ELECTRICAL CHARACTERISTICS	
IMPEDANCE	75 Ω
VOLTAGE RATING	335 V(rms)
FREQUENCY RANGE	0 ~ 1 GHz
DIELECTRIC WITHSTANDING VOLTAGE	750 V
CONTACT RESISTANCE	CENTER CONTACT
	OUTER CONTACT
INSULATION RESISTANCE	>1000 M Ω
INSERTION LOSS	N/A
VSWR	N/A
3RD INTERMODULATION	N/A

MECHANICAL CHARACTERISTICS	
FORCE TO ENGAGE AND DISENGAGE	N/A
CENTER CONTACT RETENTION FORCE	N/A
RECOMMENDED COUPLING TORQUE	N/A
COUPLING NUT RETENTION FORCE	N/A
DURABILITY	>500 cycles

ENVIRONMENTAL PARAMETER	
TEMPERATURE RANGE	-65 $^{\circ}$ C ~ +165 $^{\circ}$ C

CUSTOMER OUTLINE DRAWING

* CUSTOMER OUTLINE DRAWING

UNLESS OTHERWISE SPECIFIED:
 1) EDGES : C0.15 MAX ;
 2) REMOVE ALL BURRS ;
 3) SURFACE ROUGHNESS : Ra1.6 ;
 4) UNITS : mm ;
 5) DIMENSIONS TOLERANCES
 DECIMALS : .x ± 0.3 .xx ± 0.2 .xxx ± 0.1 ;
 ANGLES : $\pm 5^{\circ}$.

THIRD ANGLE PROJECTION	
APPROVED :	CUSTOMER P/N :
CHECKED :	SCALE : 1 : 1
DRAWING : HYH	DATE : 2020-07-07
	PAGE : 1/1

SLK
— SUPERLINK —

TITLE : SMB FEMALE S/T FOR PCB END LAUNCH,75 Ω

DRAWING NO. : 7MBF25S-P01-003

COMPANY WEBSITE : www.slkcorp.com