

REV.	DESCRIPTION	ECN NO.	NAME	DATE
2	NEW FRAME	N/A	HYH	2020-08-25

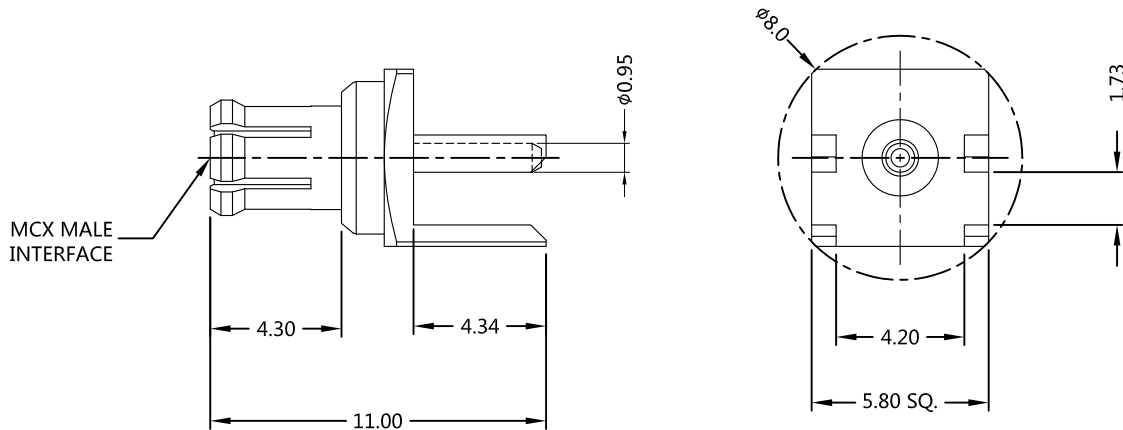

ALL PARTS MUST MEET TO RoHS REQUIREMENTS



MATERIALS AND PLATING		UNIT: MICRO-INCHES
PART NAME	MATERIALS	PLATING
BODY	BRASS C3602	GOLD PL.3u"/NICKEL/COPPER
CONTACT PIN	BRASS C3604	GOLD PL.10u"/NICKEL/COPPER
INSULATOR	PTFE ASTMD-1710	N/A
OUT CONTACT	BE-CU C17300	GOLD PL.3u"/NICKEL/COPPER

ELECTRICAL CHARACTERISTICS	
IMPEDANCE	50 Ω
VOLTAGE RATING	170 V(rms)
FREQUENCY RANGE	0 ~ 6 GHz
DIELECTRIC WITHSTANDING VOLTAGE	>750 V
CONTACT RESISTANCE	CENTER CONTACT
	OUTER CONTACT
INSULATION RESISTANCE	>1000 MΩ
INSERTION LOSS	< 0.1X \sqrt{F} (GHz) dB
RETURN LOSS	N/A
VSWR	<1.30
3RD INTERMODULATION	N/A

MECHANICAL CHARACTERISTICS	
FORCE TO ENGAGE	<14 lbs
FORCE TO DISENGAGE	1.8 lbs-4.5 lbs
CENTER CONTACT RETENTION FORCE	>2.25 lbs
DURABILITY	>500 cycles

ENVIRONMENTAL PARAMETER	
TEMPERATURE RANGE	-40 °C ~ +165 °C

*** CUSTOMER OUTLINE DRAWING**

UNLESS OTHERWISE SPECIFIED:
 1) EDGES : C0.15 MAX ;
 2) REMOVE ALL BURRS ;
 3) SURFACE ROUGHNESS : Ra1.6 ;
 4) UNITS : mm ;
 5) DIMENSIONS TOLERANCES
 DECIMALS : .x ±0.3 .xx ±0.2 .xxx±0.1;
 ANGLES : ± 5°.

THIRD ANGLE PROJECTION

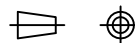

APPROVED :

CUSTOMER P/N :

CHECKED :

SCALE :

1 : 1

DRAWING :

HYH

DATE : 2020-08-25

PAGE : 1/1



TITLE : MCX MALE S/T FOR PCB END LAUNCH,50Ω

DRAWING NO. :

5MXM28S-P41

COMPANY WEBSITE : www.slkcorp.com

CUSTOMER OUTLINE DRAWING